

## 2B: SPUTUM TEST INSTRUCTIONS

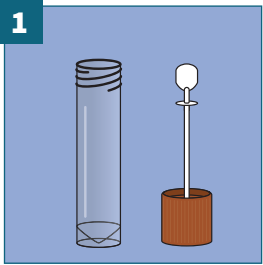

**1** Inside the package is a tube with a brown cap.

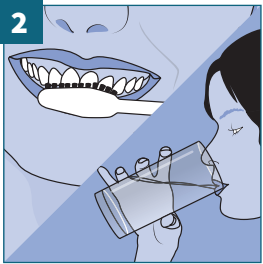

**2** Prepare by thoroughly cleaning your teeth, mouth and throat; then rinse well.

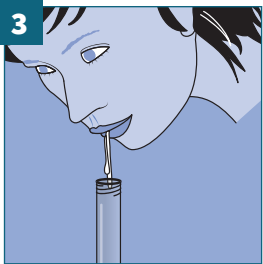

**3** Cough forcefully and collect the resultant phlegm (sputum) in the small container.

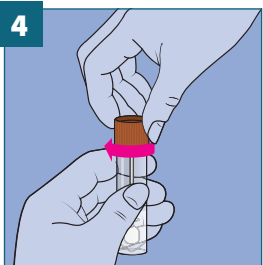

**4** Tightly screw the cap onto the tube.

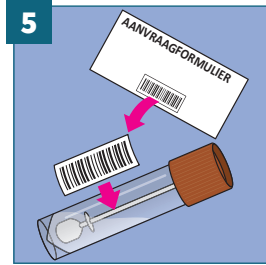

**5** Place the sticker with the barcode lengthwise on the tube. Write the collection date on the request form.

## PREPARE FOR DISPATCH

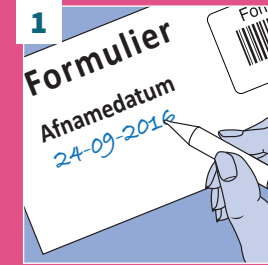

**1** Do not forget to fill in the collection date.

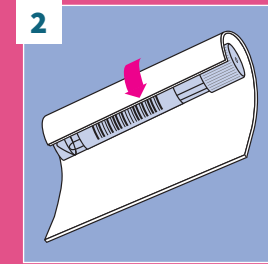

**2** Wrap the tube with the absorbent paper insert.

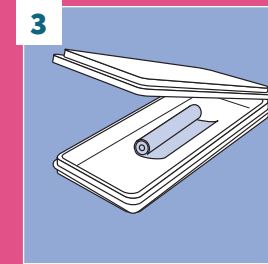

**3** Now place this inside the blister packaging.

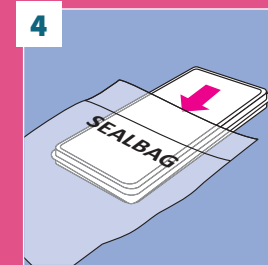

**4** Put the blister packaging into the seal bag and seal it shut.

There is an additional compartment on the non-printed side of the seal bag, insert the application form here.

Your GP will give you information on how to hand in the material.