

2A: FAECES (STOOL) TEST INSTRUCTIONS

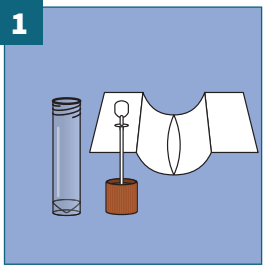

1

The package contains a
• tube with a brown cap
• faeces catcher

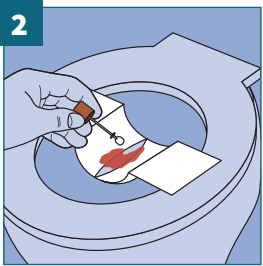

2

Use the faeces collector (to prevent cross contaminating the sample with toilet water). To capture the stool sample, follow the instructions on the faeces collector.

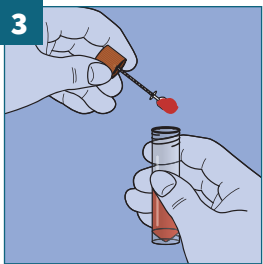

3

Fill no more than half of the tube with faeces (stool). Use the faeces collector and the spoon that is attached to the cap to fill the tube.

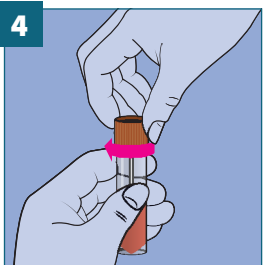

4

Tightly screw the cap onto the tube.

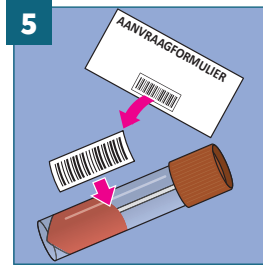

5

Place the sticker with the barcode lengthwise on the tube. Write the collection date on the request form.

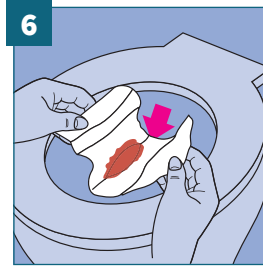

6

You can use the toilet to clean the faeces collector after it has been used.

PREPARE FOR DISPATCH

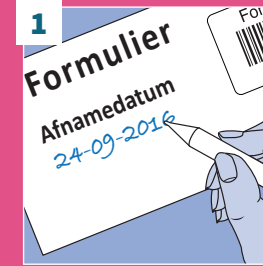

1

Do not forget to fill in the collection date.

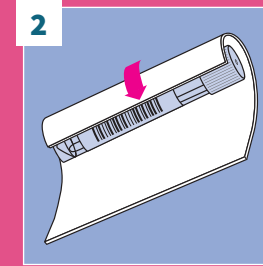

2

Wrap the tube with the absorbent paper insert.

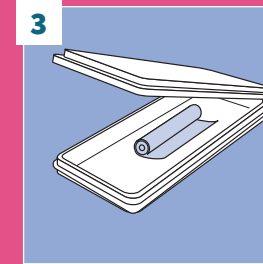

3

Now place this inside the blister packaging.

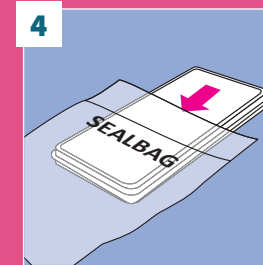

4

Put the blister packaging into the seal bag and seal it shut.

There is an additional compartment on the non-printed side of the seal bag, insert the application form here.

Your GP will give you information on how to hand in the material.