

3B: ANAL/RECTAL SMEAR TEST INSTRUCTIONS

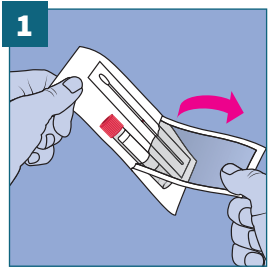

1

The package contains a
 • cotton swab
 • tube with transport fluid

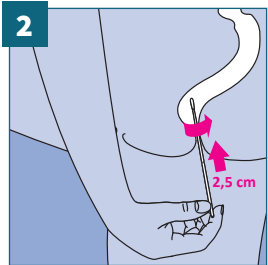

2

Then insert the cotton swab approximately 2.5 cm inside the anus.

Rotate the stick for 5 to 10 seconds along the interior of the anus (rectum).

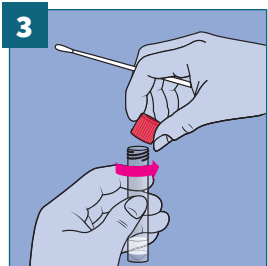

3

Open the tube with the transport liquid, making sure to hold it upright.

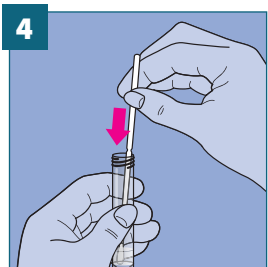

4

After taking the smear, place the cotton swab at the bottom of the transport tube.

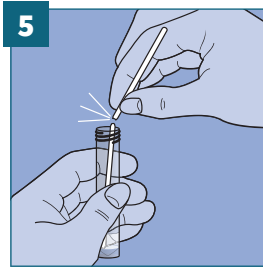

5

Break the top of the stick off at the coloured break point.

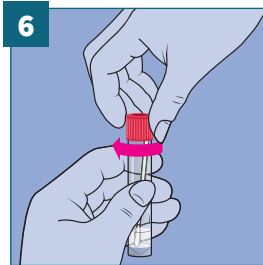

6

Tightly screw the cap onto the tube.

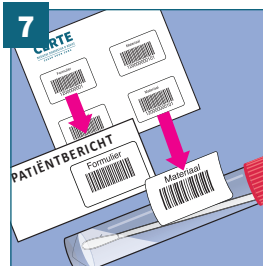

7

Affix the 'form' sticker to the patient message form and the 'material' sticker to the tube. Be sure to place the sticker with the barcode lengthwise on the tube.

Write the collection date on the patient message form.

PREPARE FOR DISPATCH

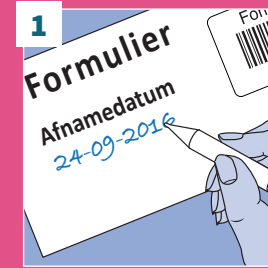

1

Do not forget to fill in the collection date.

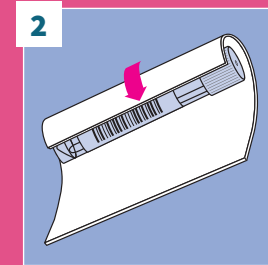

2

Wrap the tube with the absorbent paper insert.

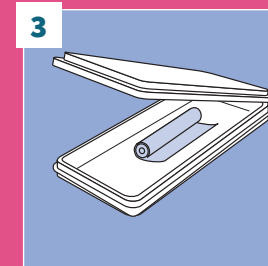

3

Now place this inside the blister packaging.

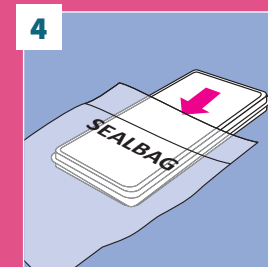

4

Put the blister packaging into the seal bag and seal it shut.

There is an additional compartment on the non-printed side of the seal bag, insert the application form here.

Your GP will give you information on how to hand in the material.