

1A: URINE SAMPLE INSTRUCTIONS

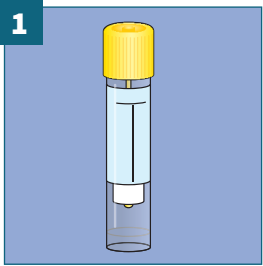

1 Inside the package is a tube with a yellow cap.

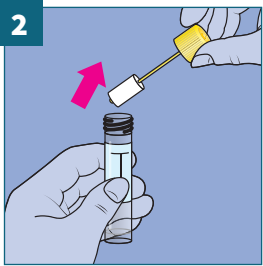

2 Loosen this cap and remove the holder with sponges from the tube.

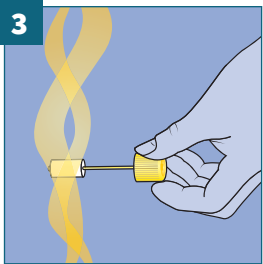

3 A few seconds after beginning to urinate, hold the sponges in the urine stream

PLEASE NOTE: the sponges must be completely saturated.

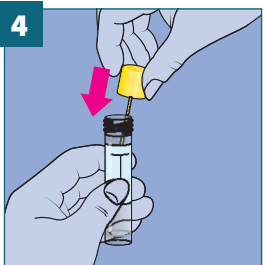

4 Insert the holder with sponges back inside the tube.

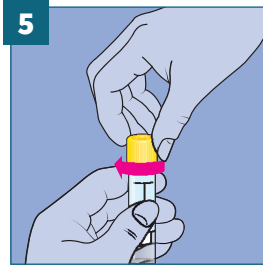

5 Tightly screw the cap onto the tube.

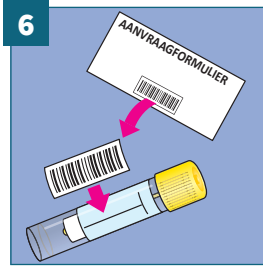

6 Place the sticker with the barcode lengthwise on the tube. Write the collection date on the request form.

PREPARE FOR DISPATCH

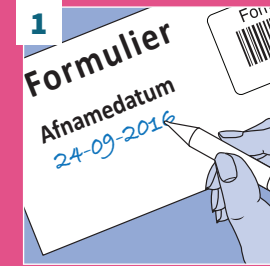

1 Do not forget to fill in the collection date.

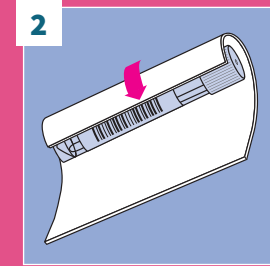

2 Wrap the tube with the absorbent paper insert.

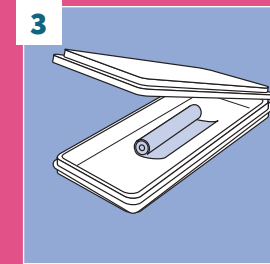

3 Now place this inside the blister packaging.

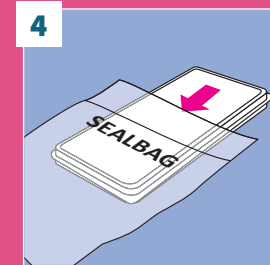

4 Put the blister packaging into the seal bag and seal it shut.

There is an additional compartment on the non-printed side of the seal bag, insert the application form here.

Your GP will give you information on how to hand in the material.